

GENESEO LUNCH FLY-OUT

The fly-out for lunch at the Geneseo-Gen-Airpark will be sponsored by the members of Gen-Air, Inc. We urge all Stearman pilots to participate in this event.

The Gen-Airpark airport (3G8) is a privately owned, public use grass airport which is located 2 miles SE of the city of Geneseo, Illinois just to the north of Interstate 80. The magnetic course from Galesburg is 021 degrees for 33 NM. There is a single grass east/west runway. Runway 9/27 is listed as 2055 feet long and 145 feet wide. However, this width is for the **ENTIRE** grass area. **THE ACTUAL LANDING AREA BETWEEN THE RUNWAY LIGHTS IS APPROXIMATELY 90 FEET.** Thus there remains approximately 55 feet of taxiway area on the north side of the runway. This taxi area has a couple of small swales in it, but it is useable for taxi by Stearmans. The runway has a displaced threshold of 300 feet on the east end and 240 feet on the west end. The beginning of the useable runway is designated by white gravel runway end markings. There are power lines along the roads approaching the runway, but the lines are buried underground at the runway ends. At the approach end of Runway 9 on the north side there is a house and three trees which are approximately 100 feet high.

The airport will have a temporary mobile control tower which will operate on the Common Traffic Advisory Frequency (CTAF) of 122.9. This is not an official control tower—but will be available for traffic advisories and other information. It will be manned by FAA Air Traffic Controllers from the Moline, Illinois ATC facility. Their call sign will be "Geneseo Radio". If your airplane is radio equipped, please contact them on 122.9 for advisories upon arrival and departure. While this tower **WILL NOT** control traffic and **WILL NOT** issue take-off or landing clearances, if they make suggestions such as "Go around", "Please expedite", etc., please comply. **REMEMBER—THE PILOT HAS THE FINAL AND ULTIMATE RESPONSIBILITY FOR SPACING FOR LANDING AND TAKE-OFF.**

The main Stearman parking area is a large rectangular parking area on the north side of the runway near the T-hangars. Additional parking may be used near the houses at each end of the runway. There will be volunteers to direct the Stearmans to the parking area.

Departure after lunch will be individually or as arranged by each pilot. Please contact "Geneseo Radio" on 122.9 for advisories.

FLY SAFELY – FLY COURTEOUSLY

REMEMBER – THE FEDS ARE EVERYWHERE!

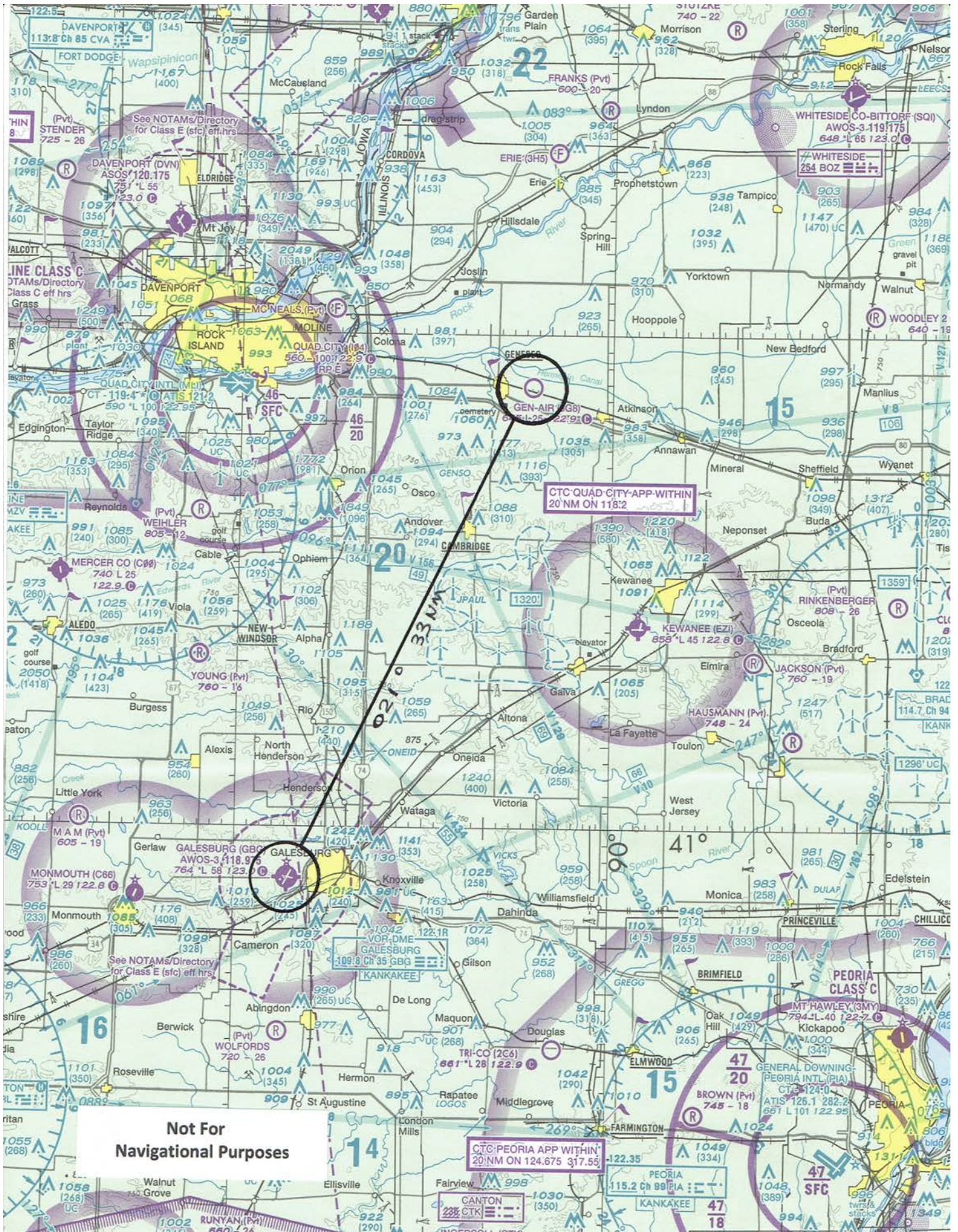

Not For
Navigational Purposes

CTC QUAD CITY APP WITHIN
20 NM ON 118:2

CTC PEORIA APP WITHIN
20 NM ON 124.675 317.55

CANTON
238 CTK

GENESEO - GEN - AIRPARK

ELEV. - 645 FT.

LEFT HAND PATTERN - 1500' MSL

CTAF - 122.9

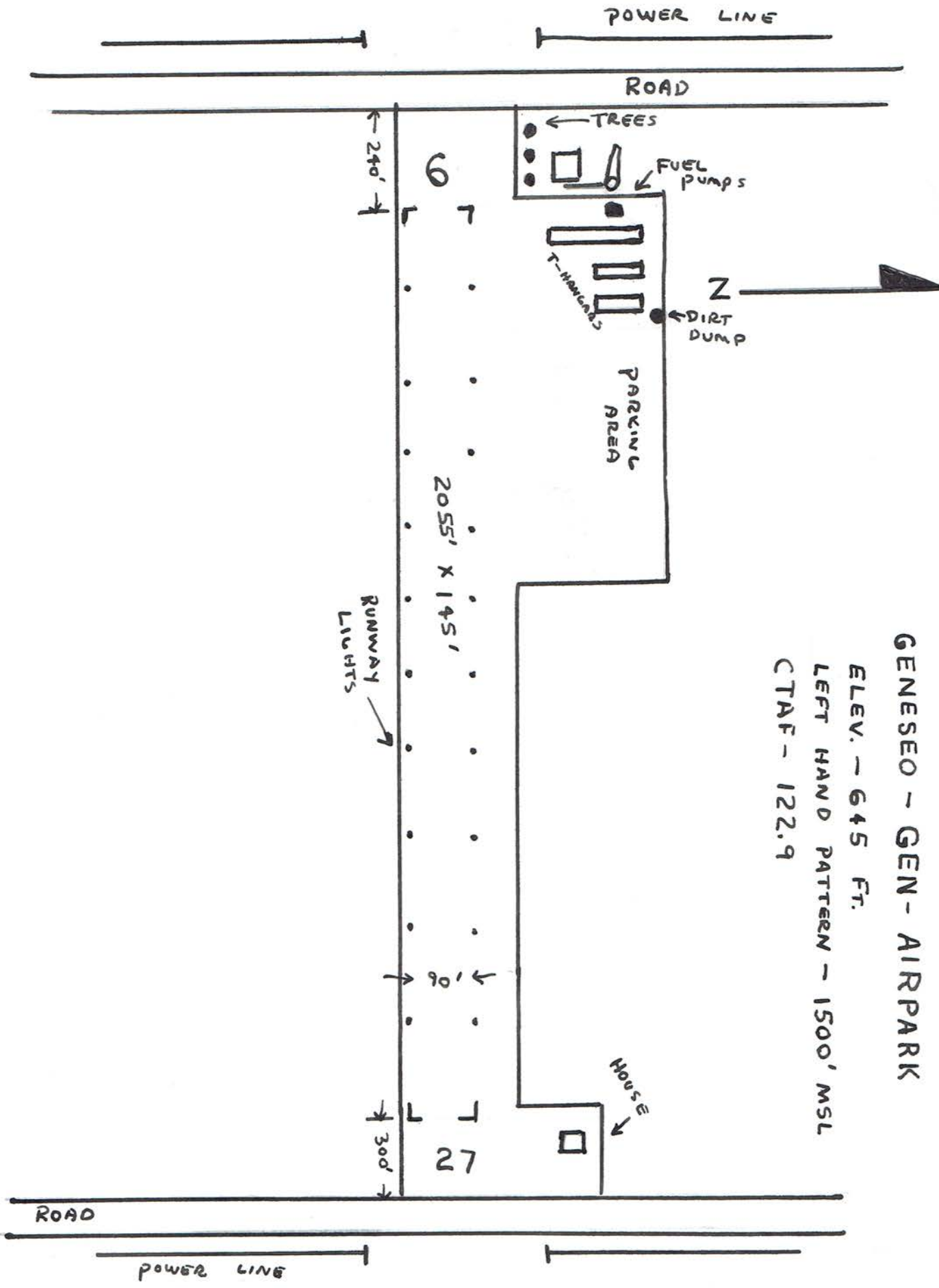

Airspace Class: G

Geneseo-Gen-Airpark

3G8

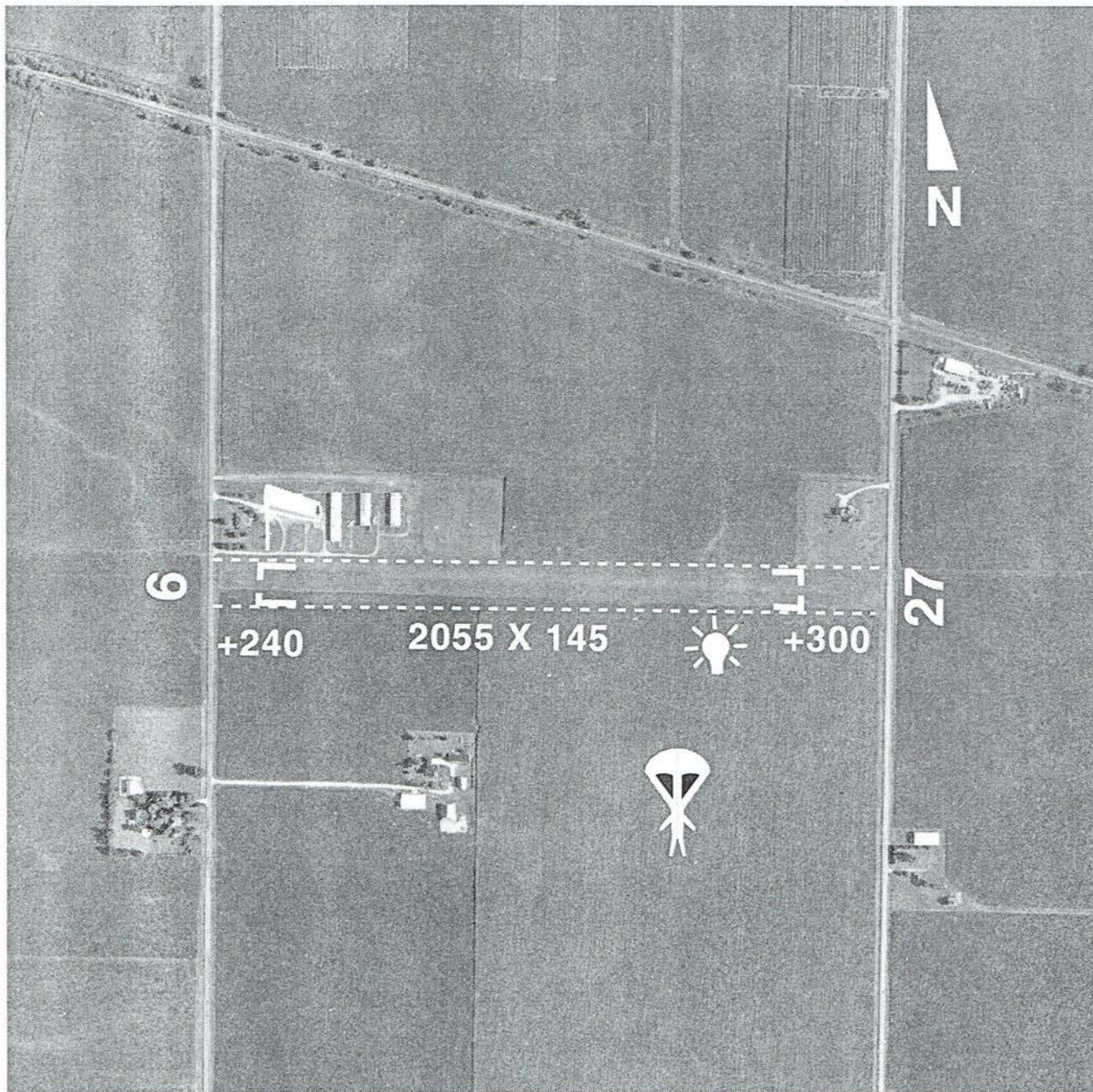

Communication	TWR/CTAF:	122.9	Navigation	ELEV:	645'	Services	FUEL:	
	GND CON:			LAT:	41°26.39'		FBO:	
	ATIS:			LON:	90°06.61'			
	UNICOM:			VOR:	114.4 MZV			
	APP/DEP:			065°	25.2 NM			
	RCO:			AWOS:				
LIGHTS:	122.9							